

DO NOT SCALE FROM THIS DRAWING

THIS DRAWING IS TO BE READ IN CONJUNCTION WITH ALL OTHER HBL DRAWINGS ISSUED FOR THIS PROJECT

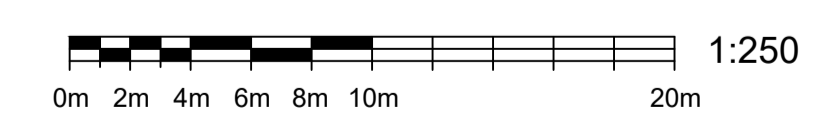
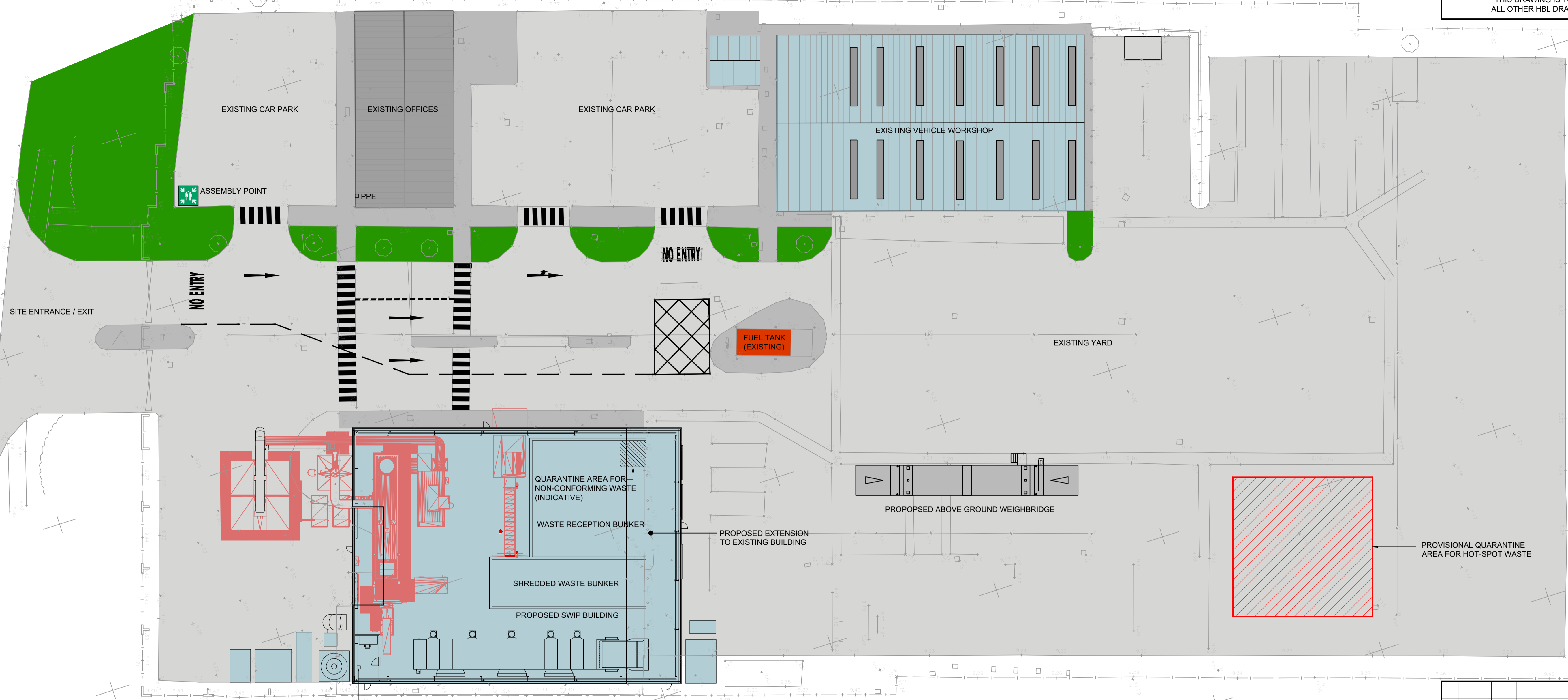
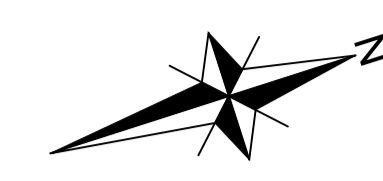

P1	JUN'18	JW	PLANT UPDATED	SBH	SBH
REV.	DATE	DRAWN	DESCRIPTION	CHKD	APPRD

**HBL ASSOCIATES Ltd.**  
 CONSULTING CIVIL AND STRUCTURAL ENGINEERS  
 318 Shaw Road, Hazam Moor, Stockport SK4 4AG  
 Telephone 0161 432 9977  
 Facsimile 0161 432 9979  
 Email: [consultants@hblasociates.co.uk](mailto:consultants@hblasociates.co.uk)  
 © COPYRIGHT RESERVED HBL ASSOCIATES LTD.

THIS INFORMATION IS CONFIDENTIAL AND THE PROPERTY OF BIFFA WASTE SERVICES LTD. AND IS RELEASED ON CONDITION THAT NONE OF THE INFORMATION SHALL BE DISCLOSED TO ANY THIRD PARTY OR REPRODUCED IN WHOLE OR PART WITHOUT THE PRIOR CONSENT IN WRITING OF BIFFA WASTE SERVICES LTD.

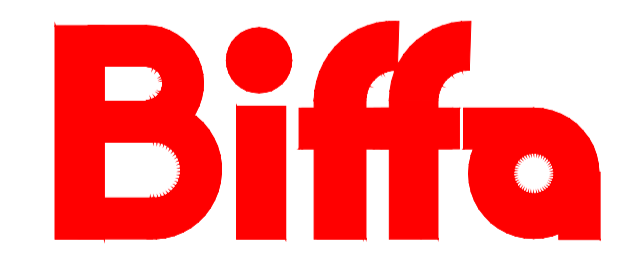

STATUS		<b>PRELIMINARY</b>	
CLIENT	BIFFA WASTE SERVICES	DRAWN	T.A.TAYLOR
PROJECT	SWIP	CHECKED	S.B.HOLMES
LOCATION	SWANSEA	APPROVED	S.B.HOLMES
DRAWING TITLE	SWIP BUILDING PROPOSED SITE LAYOUT	DATE	JANUARY 2018
		SCALE(S)	1:250
			<b>A1</b>
DRAWING No.	02	HBL REF.	6454
		REVISION	<b>P1</b>

FILE REF: R\JOBS CURRENT\